

WA No.	2022-009
Date	06 JUNE 2023
Drawn	LMV/SD
Checked	LMV

NO.	DATE	DESCRIPTION
1	06/06/2023	ISSUE FOR PERMIT
2	08/14/2023	ISSUE FOR PERMIT REVISION 1
3	09/12/2023	LANDSCAPE PLAN REVISIONS
4	10/24/2023	LANDSCAPE PLAN REVISIONS

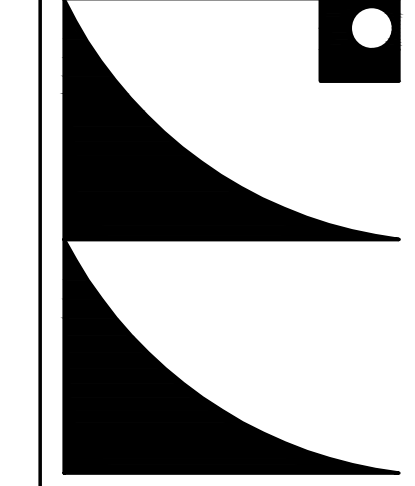

**WILLIAMS ARCHITECTS**  
ARCHITECTURE | PLANNING | AQUATICS | INTERIORS  
500 Park Boulevard, Suite 800, Itasca, IL 60143  
Phone 630-221-1212 / Fax 630-221-1220



LANDSCAPE  
SITE  
DEVELOPMENT

**L1.0**

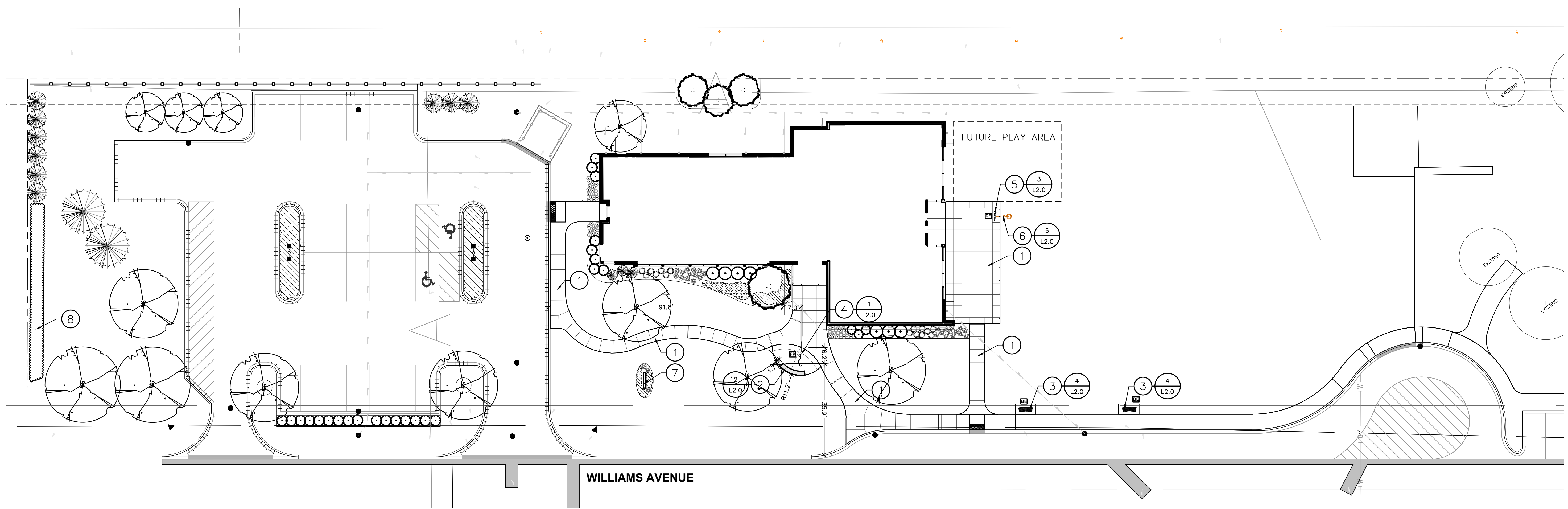

**1 LANDSCAPE SITE DEVELOPMENT**  
L1.0

**TREE PRESERVATION NOTES:**

- DURING CONSTRUCTION TAKE ALL REASONABLE STEPS NECESSARY TO PREVENT THE DESTRUCTION OR DAMAGE TO TREES (OTHER THAN THOSE SPECIFIED TO BE REMOVED), INCLUDING, BUT NOT LIMITED TO THE FOLLOWING:
- NO CONSTRUCTION ACTIVITY, MOVEMENT AND/OR PLACEMENT OF EQUIPMENT OR MATERIAL OR SPOILS STORAGE SHALL BE PERMITTED OUTSIDE THE CONSTRUCTION LIMITS OR WITHIN THE TREE PRESERVATION AREA. NO EXCESS SOIL, ADDITIONAL FILL, LIQUIDS OR CONSTRUCTION DEBRIS SHALL BE PLACED WITHIN THE ROOT ZONE OF ANY TREE THAT IS REQUIRED TO REMAIN.
  - CRUSHED LIMESTONE, HYDROCARBONS AND OTHER MATERIALS DETRIMENTAL TO TREES SHALL NOT BE DUMPED WITHIN THE ROOT ZONE OF ANY TREE, NOR AT ANY HIGHER LOCATION WHERE DRAINAGE TOWARD THE TREE COULD CONCEIVABLY AFFECT THE HEALTH OF THE TREE.
  - APPROPRIATE PROTECTIVE FENCING SHALL BE TEMPORARILY INSTALLED FOR PROTECTION OF REMAINING TREES. APPROPRIATE PROTECTIVE FENCING SHALL INCLUDE WOODEN SNOW FENCE OR VINYL CONSTRUCTION FENCE.
  - ALL REQUIRED PROTECTIVE FENCING OR OTHER PHYSICAL BARRIER MUST BE IN PLACE AND APPROVED BY THE LANDSCAPE ARCHITECT PRIOR TO BEGINNING CONSTRUCTION. THE FENCING MUST REMAIN IN PLACE DURING THE ENTIRE CONSTRUCTION PERIOD TO PREVENT THE IMPINGEMENT OF CONSTRUCTION VEHICLES, MATERIALS, SPOILS AND EQUIPMENT INTO OR UPON THE TREE PRESERVATION AREA.
  - NO ATTACHMENTS, FENCES OR WIRES, OTHER THAN THOSE APPROVED FOR BRACING, GUYING OR WRAPPING, SHALL BE ATTACHED TO TREES DURING THE CONSTRUCTION PERIOD.
  - UNLESS OTHERWISE INDICATED ON THE PLANS, NO SOIL IS TO BE REMOVED FROM WITHIN THE ROOT ZONE OF ANY TREE THAT IS TO REMAIN.
  - WHERE CONSTRUCTION TAKES PLACE WITHIN THE CRITICAL ROOT ZONE OF ONE SIDE OF A TREE PROPOSED FOR PRESERVATION, PROTECTIVE FENCING SHALL BE EXTENDED BEYOND THE CRITICAL ROOT ZONE OF THE OTHER SIDE OF THE TREE TO MAXIMIZE PROTECTION OF THE ROOT SYSTEM.
  - TREES WHICH ARE PRESERVED, BUT WILL BE AFFECTED DURING THE CONSTRUCTION PROCESS SHALL HAVE THE CROWNS AND ROOTS PRUNED BY A CERTIFIED ARBORIST ACCORDING TO THE TREE PRUNING STANDARDS SET BY ANSI Z100.
  - IF, IN THE OPINION OF THE LANDSCAPE ARCHITECT, THE NECESSARY PRECAUTIONS AS SPECIFIED WERE NOT UNDERTAKEN BEFORE CONSTRUCTION COMMENCED, OR ARE NOT MAINTAINED AT ANY TIME DURING CONSTRUCTION, A STOP WORK ORDER SHALL BE ISSUED UNTIL SUCH TIME AS THE CONTRACTOR COMPLIES WITH THE PRECAUTIONS HEREIN.
  - SEE ALSO CIVIL ENGINEERING PLANS.

**CONSTRUCTION PLAN GENERAL NOTES:**

- EXISTING TOPOGRAPHY AND SPOT ELEVATIONS SHALL BE VERIFIED BY THE CONTRACTOR PRIOR TO COMMENCING WORK. REPORT ANY DISCREPANCIES TO THE LANDSCAPE ARCHITECT AS SOON AS THEY ARE DISCOVERED. PROPOSED GROUND ELEVATIONS MAY BE REVISED TO MEET FIELD CONDITIONS.
- THE CONTRACTOR SHALL RECEIVE NO ADDITIONAL COMPENSATION FOR CONSTRUCTION STAGING NECESSARY TO ACCOMMODATE UTILITY RELOCATION OR ADJUSTMENT AND/OR FOR DELAYS CAUSED BY UTILITY RELOCATION OR ADJUSTMENT.
- DEBRIS DEPOSITED IN THE FLOW OF ANY STRUCTURES SHALL BE REMOVED AT THE CLOSE OF EACH WORKING DAY. AT THE CLOSE OF CONSTRUCTION OPERATIONS, ALL STRUCTURES SHALL BE FREE FROM DIRT AND DEBRIS. THIS WORK WILL NOT BE PAID FOR SEPARATELY BUT SHALL BE INCIDENTAL TO THE CONTRACT.
- THE CONTRACTOR SHALL ADHERE TO LIMITS OF RESTORATION SHOWN. WORK OUTSIDE THESE LIMITS WILL NOT BE PAID FOR UNLESS AUTHORIZED BY THE LANDSCAPE ARCHITECT.
- CONSTRUCTION STAKING FOR THE PROJECT SHALL BE PERFORMED BY THE CONTRACTOR AND CONSIDERED INCIDENTAL TO THE CONTRACT.
- ALL FRAMES AND GRATES DAMAGED BY THE CONTRACTOR DURING CONSTRUCTION WILL BE REPLACED BY THE CONTRACTOR AT HIS EXPENSE.
- NO CONCRETE SHALL BE INSTALLED UNTIL THE FORMS HAVE BEEN INSPECTED FOR LINE, GRADE AND SUBGRADE CONDITIONS BY THE LANDSCAPE ARCHITECT. IT IS REQUIRED THAT THE INSPECTIONS BE ARRANGED FOR AT LEAST 24 HOURS IN ADVANCE OF THE CONCRETE PLACEMENT.
- SIDEWALK RAMPS AND/OR DEPRESSED CURBS SHALL BE PROVIDED AT THE LOCATIONS SHOWN ON THE CIVIL PLANS. SIDEWALK RAMPS AND/OR DEPRESSED CURBS SHALL BE CONSTRUCTED IN ACCORDANCE WITH THE APPLICABLE STATE STANDARDS.
- A SMOOTH TRANSITION SHALL BE EFFECTED BETWEEN NEW AND EXISTING CONSTRUCTION, DIFFERENT PHASES OF CONSTRUCTION, AND TEMPORARY CONSTRUCTION.
- ALL TURF AND PLANTING AREAS SHALL DRAIN COMPLETELY AND NOT POND NOR PUDDLE. PROVIDE 6" OF BLACK TOPSOIL IN ALL AREAS WHICH HAVE BEEN REGRADED OR DISTRIBUTED DURING CONSTRUCTION.
- THE LANDSCAPE ARCHITECT SHALL REVIEW ALL HARDSCAPE SURFACE PAVEMENT ELEVATIONS PRIOR TO CONSTRUCTION. GIVE LANDSCAPE ARCHITECT 24 HOURS NOTICE. ALL HARD SURFACE PAVEMENTS SHALL DRAIN COMPLETELY AT 1.0% MIN. SLOPE (UNLESS OTHERWISE SPECIFIED).
- INTENTIONALLY OMITTED.
- WHEN EXCAVATING, BACKFILLING, OR GRADING BENEATH TREE DRIFLINE, REVIEW ALL PROPOSED WORK WITH THE LANDSCAPE ARCHITECT.
- FINISHED GRADE ELEVATIONS IN TURF AND LANDSCAPED AREAS SHALL BE APPROXIMATELY 2" ABOVE ADJACENT PAVEMENTS, CURBS, ETC. TO ALLOW FOR SETTLEMENT.

**SITE CONSTRUCTION PLAN NOTES:**

- 5" REINFORCED CONCRETE WALK. SCORE WALK IN 5' MODULES OR AS SHOWN AND PROVIDE 1/2" EXPANSIONS JOINTS AT 30' INTERVALS OR AS SHOWN. BACKFILL WALK WHERE APPLICABLE WITH TOPSOIL BY AN APPROVED METHOD. SEE ALSO CIVIL PLANS.
- FURNISH AND INSTALL POURED IN PLACE CONCRETE SEAT WALL AT 24" HEIGHT WITH SIMULATED STONE VENEER AND CAST STONE GAP. SEE DETAIL AND SPECIFICATIONS.
- INSTALL BENCH (BE) FURNISHED BY OWNER. SEE ALSO SITE FURNISHINGS SCHEDULE.
- FURNISH AND INSTALL FLAGPOLE. SEE SITE FURNISHINGS SCHEDULE AND DETAIL.
- FURNISH AND INSTALL DRINKING FOUNTAIN. SEE ALSO SITE FURNISHINGS SCHEDULE AND PLUMBING PLANS.
- FURNISH AND INSTALL DRYWELL. 5 LF OF 4" PVC TO DRY WELL @ MIN. 1.0%
- PARK DISTRICT SIGN BY OWNER.
- EXISTING SHRUBS TO REMAIN. PROTECT DURING CONSTRUCTION.

**SITE FURNISHINGS SCHEDULE:**

KEY	ITEM	MODEL NUMBER	MANUFACTURER	QUANTITY	COMMENTS
BE	CURVED BENCH	R95P-120-6	DM	2	6-FOOT BENCH, S-1 (EMBEDMENT), COLOR: BLACK
DF	DRINKING FOUNTAIN	10145SM	MDF	1	BOTTLE FILLER WITH HI-LO DRINKING FOUNTAIN, ADA, WITH STAINLESS STEEL CARRIER COLOR: BLUE
FP	FLAGPOLE	ESR20841 - SAT	CO	1	CONTINENTAL SERIES, ESR EXTERNAL SINGLE REVOLVING ROPE HALYARD, GROUND SET INSTALLATION, SEE ELECTRICAL PLANS FOR LIGHT SPECIFICATIONS.

**MANUFACTURERS REPRESENTATIVES AND SUPPLIER LIST**

CD	CONCORD FLAGPOLES	CONTACT: CONCORD AMERICAN FLAGPOLE 4155 PATRIOT DRIVE SUITE 100 GRAPEVINE, TX 76051 PHONE: 972-360-8186
MDF	MOST DEPENDABLE FOUNTAINS	CONTACT: GINA WELCH PLAY DESIGN SCAPES 352 CEDAR LANE ELK GROVE VILLAGE, ILLINOIS PHONE: 224-324-4597 GINA@PLAYDESIGNSCAPES.COM
DM	DUMOR	CONTACT: RICK BIETEMAN NU-TOYS LEISURE PRODUCTS, INC. 10560 W. CERMAK RD WESTCHESTER, IL 60154 708.579.9055 RICKB@NUYOYS4FORFUN.COM

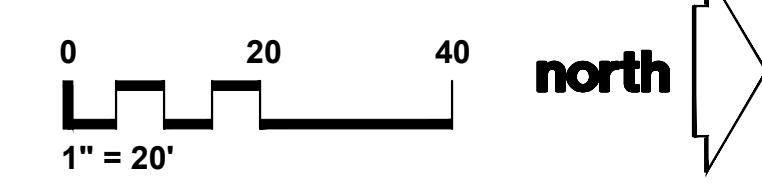

WA No.	2022-009
Date	06 JUNE 2023
Drawn	LMV/SD
Checked	LMV

NO.	DATE	DESCRIPTION
1	06/02/2023	ISSUE FOR BID
2	08/14/2023	ISSUE FOR PERMIT REVISION 1
3	09/12/2023	LANDSCAPE PLAN REVISIONS
4	10/24/2023	LANDSCAPE PLAN REVISIONS



**WILLIAMS ARCHITECTS**  
ARCHITECTURE | PLANNING | AQUATICS | INTERIORS  
500 Park Boulevard, Suite 800, Itasca, IL 60143  
Phone 630-221-1212 / Fax 630-221-1220

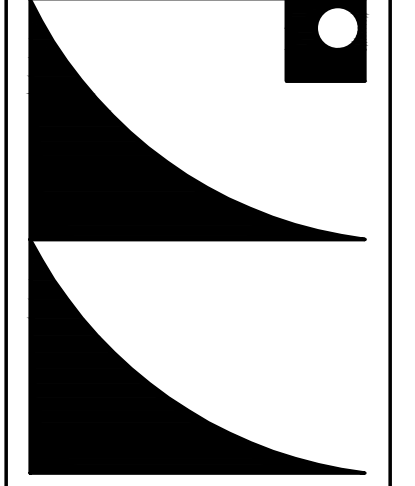

LANDSCAPE PLAN

**L1.1**

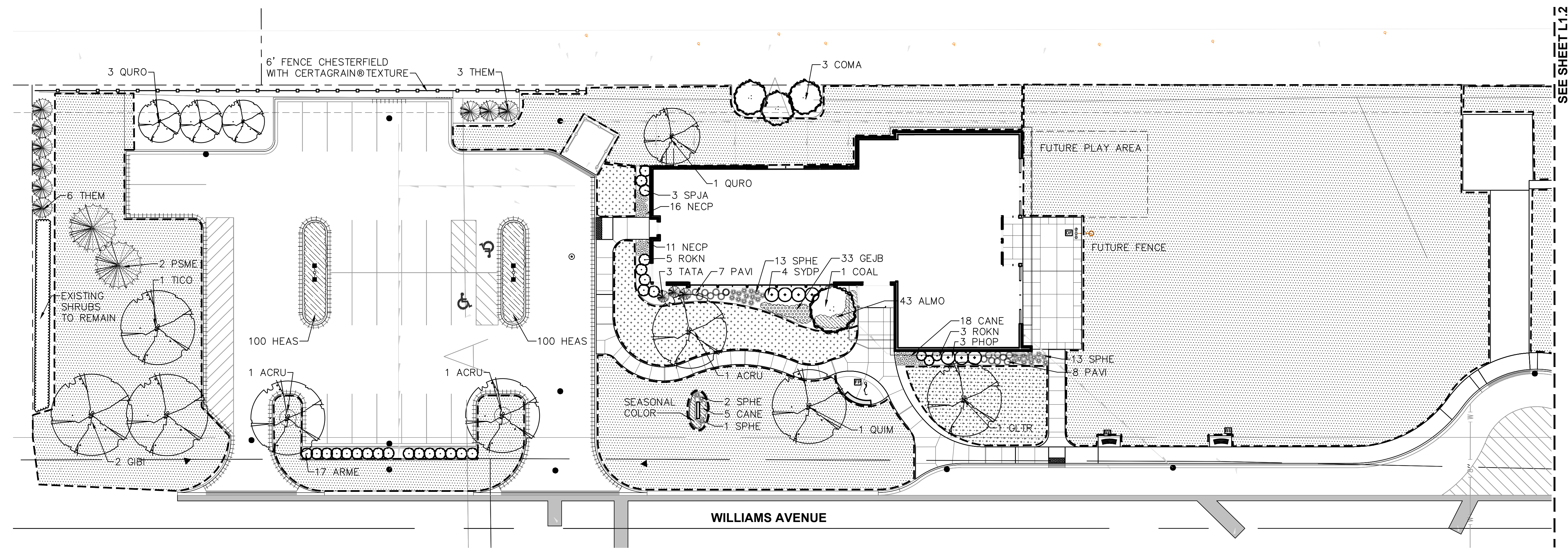

SEE SHEET L1.2

**1**  
**L1.1**  
**LANDSCAPE PLAN**

**LANDSCAPE PLAN GENERAL NOTES:**

- THE LANDSCAPE CONTRACTOR SHALL COMPLY WITH ALL PROVISIONS AND DIRECTIONS OF THE SPECIFICATIONS.
- THE LANDSCAPE CONTRACTOR SHALL PROTECT ALL WORK FROM DAMAGE BY OTHER UNTIL THE WORK IS COMPLETE AND ACCEPTED BY THE PARK DISTRICT.
- THE LANDSCAPE CONTRACTOR SHALL COORDINATE HIS WORK WITH ALL OTHER TRADES.
- EXACT LOCATION OF ALL UNDERGROUND UTILITIES SHALL BE DETERMINED AND IDENTIFIED IN THE FIELD BY THE LANDSCAPE CONTRACTOR PRIOR TO COMMENCING WORK.
- THE CONTRACTOR SHALL AVOID ALL EXISTING UTILITIES-UNDERGROUND AND OVERHEAD WHERE APPLICABLE. WHERE UNDERGROUND UTILITIES EXISTS, FIELD ADJUSTMENTS MUST BE APPROVED BY THE LANDSCAPE ARCHITECT PRIOR TO INSTALLATION. NEITHER THE OWNER NOR THE LANDSCAPE ARCHITECT ASSUMES ANY RESPONSIBILITY WHATSOEVER, IN RESPECT TO THE CONTRACTOR'S ACCURACY IN LOCATING THE INDICATED PLANT MATERIAL.
- ALL PLANT MATERIALS SHALL CONFORM TO THE LATEST EDITION OF AMERICAN STANDARD FOR NURSERY STOCK AS PUBLISHED BY THE AMERICAN NURSERY AND LANDSCAPE ASSOCIATION, 230 SOUTHERN BUILDING, WASHINGTON D.C. 20005 (ANSI Z60.1).
- ALL PLANTS OF THE SAME SPECIES SHALL BE OBTAINED FROM THE SAME NURSERY SOURCE.
- THE LANDSCAPE CONTRACTOR SHALL STAKE THE LOCATION OF ALL TREES AND OTHER LANDSCAPE FEATURES FOR REVIEW AND APPROVAL BY THE LANDSCAPE ARCHITECT AND SHALL CHECK FOR CORRECT SPACING BEFORE PLANTING.
- THE CONTRACTOR SHALL GIVE AT LEAST 48 HOURS NOTICE TO THE LANDSCAPE ARCHITECT AS EACH PHASE OF WORK IS UNDERTAKEN PRIOR TO PLANTING OPERATIONS SO THAT THE LANDSCAPE ARCHITECT CAN BE PRESENT TO VERIFY PLANT SPECIES, SIZES AND OVERALL HEIGHT IMMEDIATELY PRIOR TO PLANTING. IF NOTICE IS NOT GIVEN BY THE CONTRACTOR, HE SHALL REMOVE/REPLACE PLANTS AS DIRECTED BY THE LANDSCAPE ARCHITECT AT NO ADDITIONAL EXPENSE TO THE OWNER.
- PLANT TREES AND SHRUBS AFTER THE FINAL GRADES HAVE BEEN ESTABLISHED AND PRIOR TO THE PLANTING OF LAWNS UNLESS OTHERWISE DIRECTED BY THE OWNER. IF PLANTING OF TREES OCCURS AFTER LAWN WORK, THE LANDSCAPE CONTRACTOR SHALL PROTECT LAWN AREAS AND PROMPTLY REPAIR DAMAGED LAWN RESULTING FROM PLANTING OPERATIONS.
- ALL PLANT MATERIAL SHALL BEAR THE SAME RELATIONSHIP TO THE NEW GRADE AS IT BORE TO THE GRADE AT THE NURSERY.
- PRUNE BROKEN OR CROSS BRANCHING AT THE TIME OF PLANTING. DO NOT REMOVE CENTRAL LEADER.
- FOR TREES PLANTED IN TURF AREAS, THE LANDSCAPE CONTRACTOR SHALL PROVIDE A 6"-0" DIA. SHREDDED HARDWOOD BARK MULCH RING (REMOVE EXISTING TURF) AT A MINIMUM OF 3" THICK (AFTER SETTLEMENT) WITH A CULTIVATED EDGE AT THE BASE OF EACH TREE. MULCH SHALL BE PLACED WITHIN TWO (2) DAYS AFTER TREES ARE PLANTED. MULCH SHALL BE CONSIDERED INCIDENTAL TO TREE PLANTINGS. INCLUDE TERRA-SORB HYDROGEL CRYSTALS WITH PLANTING MIX.
- TREES SHALL BE SET IN TRUE, VERTICAL ALIGNMENT AFTER PLANTING.
- ALL PLANTS SHALL BE PLANTED PER THE LANDSCAPE PLAN, DETAILS AND SPECIFICATIONS. PLANTINGS NOT FOUND TO BE IN COMPLIANCE SHALL BE REPLANTED CORRECTLY, OR REPLACED AT NO ADDITIONAL EXPENSE TO THE OWNER.
- ADJUST SHRUB, PERENNIAL, AND GROUNDCOVER SPACING AS NECESSARY TO EVENLY FILL PLANTING BEDS.
- THE LANDSCAPE ARCHITECT OR OWNER RESERVES THE RIGHT TO REJECT PLANTS ON SITE WHETHER STOCK PILED OR PLANTED IN PLACE. REJECTED PLANTS SHALL BE REMOVED IMMEDIATELY FROM SITE.
- IN CASE OF DISCREPANCIES BETWEEN THE PLAN AND THE PLANT LIST, THE PLAN SHALL DICTATE.
- WHERE PLANTING BEDS MEET TURF AREAS, THE CONTRACTOR SHALL PROVIDE A CULTIVATED EDGE. MULCH ALL SHRUB BEDS TO THE LINE SHOWN. THE CONTRACTOR SHALL FURNISH AND INSTALL 3" LAYER OF SHREDDED HARDWOOD MULCH UNDER ALL TREE PLANTINGS AND SHRUB BEDS. (SUBMIT SAMPLE, SEE SPECS.)
- AN APPROVED GRANULAR ORGANIC PRE-EMERGENT HERBICIDE SHALL BE APPLIED IN ALL PLANTING BEDS AT A RATE SPECIFIED BY MANUFACTURER FOR EACH PLANT VARIETY.
- THE LANDSCAPE CONTRACTOR SHALL TAKE NECESSARY PRECAUTIONS TO PREVENT INJURY TO ALL PLANT MATERIAL DURING DIGGING, HANDLING, PLANTING, AND MAINTENANCE OPERATIONS.
- ALL PLANTS TO BE "HEELED IN" OR STORED ON-SITE AND SHALL BE GROUPED TOGETHER BY SPECIES AND SIZE AND SHALL BE COVERED WITH MULCH OR COMPOST TO PREVENT DESICCATION. DO NOT DELIVER ANY PLANTS THAT CANNOT BE PLANTED WITHIN FIVE (5) WORKING DAYS.
- FOR ALL GROUNDCOVERS, ROTOTILL 2" OF SPHAGNUM PEAT INTO TOPSOIL TO A DEPTH OF 6" TO YIELD A HOMOGENOUS MIXTURE OF TOPSOIL AND PEAT.
- GROUNDCOVER AREAS SHALL ONLY RECEIVE 1 1/2" SHREDDED HARDWOOD MULCH (NO FABRIC). CAREFULLY PLACE MULCH AROUND EACH PLANT BASE.
- BERMS AND LANDFORMS SHOWN ARE APPROXIMATE ONLY. THE CONTRACTORS SHALL UTILIZE EXISTING SUBSOIL AND TOPSOIL. THE CONTRACTOR SHALL GRADE AS SHOWN. THE CONTRACTOR SHALL BE AWARE OF SUCH QUANTITIES PRIOR TO SUBMITTING THE BID.
- ALL EXCAVATED TOPSOIL SHALL BE RE-USED BY THE CONTRACTOR OR IF CONSTRUCTION YIELDS ADDITIONAL TOPSOIL, IT SHALL BE STOCKPILED ON SITE IN AN AREA DESIGNATED BY THE OWNER FOR RE-USE BY THE CONTRACTOR PRIOR TO IMPORTING NEW TOPSOIL (IF ANY).
- ALL DISTURBED AREAS SHALL RECEIVE 6" MINIMUM OF TOPSOIL (COMPACTED). LANDSCAPE CONTRACTOR TO COORDINATE THEIR WORK WITH OTHER TRADES REGARDING FINISH GRADING. IF AVAILABLE, CONTRACTOR IS TO USE STOCKPILED TOPSOIL ON-SITE. IF NOT AVAILABLE THE LANDSCAPE CONTRACTOR WILL BE RESPONSIBLE FOR IMPORTING THE TOPSOIL NECESSARY TO MEET FINISH GRADE.
- TOPSOIL SHALL BE FERTILE, FRIABLE AND REPRESENTATIVE

OF LOCAL PRODUCTIVE SOIL, CAPABLE OF SUSTAINING VIGOROUS PLANT GROWTH AND FREE OF CLAY LUMPS, SUBSOIL, NOXIOUS WEEDS OR OTHER FOREIGN MATTER SUCH AS STONES, ROOTS, STICKS AND OTHER EXTRANEOUS MATERIALS; NOT FROZEN OR MUDDY. PH OF TOPSOIL TO RANGE BETWEEN 5.5 AND 7.5.

FINE GRADE, FERTILIZE, AND SEED/SOD ALL DISTURBED AREAS WITHIN THE CONSTRUCTION LIMITS AS SHOWN ON THE PLANS. SEEDED AREAS SHALL HAVE EROSION CONTROL BLANKET. ALL TURF AREAS SHALL DRAIN COMPLETELY AND SHALL NOT POND NOR PUDDLE. ALL TURF AREAS SHALL RECEIVE 6" THICK BLACK TOPSOIL-ALLOW FOR SETTLEMENT.

DURING LANDSCAPE WORK, KEEP PAVEMENTS CLEAN AND WORK AREAS IN AN ORDERLY MANNER. REMOVE ALL DEBRIS FROM THE JOB SITE ON A DAILY BASIS.

ALL PLANT MATERIAL SHALL BE FULLY GUARANTEED FOR ONE YEAR FROM THE DATE OF FINAL ACCEPTANCE. DEAD OR UNHEALTHY PLANTS SHALL BE REPLACED AS SOON AS CONDITIONS PERMIT.

SUBSTITUTION OF PLANT MATERIAL DUE TO LACK OF AVAILABILITY MUST BE APPROVED BY THE LANDSCAPE ARCHITECT. SUBSTITUTE PLANTS SHALL BE THE SAME SIZE, OR LARGER, AND OF EQUAL OR BETTER VALUE THAN THE ITEMS SPECIFIED. THE "EQUALITY" WILL REST WITH THE SOLE JUDGEMENT OF THE LANDSCAPE ARCHITECT.

ALL LANDSCAPE MATERIALS MUST BE MAINTAINED IN GOOD CONDITION, PRESENT A HEALTHY, NEAT, AND ORDERLY APPEARANCE, AND BE KEPT FREE OF REFUSE AND DEBRIS. ANY DEAD, UNHEALTHY, OR MISSING PLANTS MUST BE REPLACED WITHIN 60 DAYS OF NOTIFICATION, UNLESS AN EXTENSION IS APPROVED.

DORMANT SEED IN NOVEMBER WHEN GROUND IS NOT FROZEN, YET COLD ENOUGH SO GERMINATION WILL NOT OCCUR. BARE SOIL SHOULD BE LOOSENED SO THE SEED CAN EASILY BE INCORPORATED INTO THE FIRST HALF-INCH OF THE SURFACE. WATER THOROUGHLY AND LEAVE UNTIL SPRING.

THE LANDSCAPE CONTRACTOR SHALL SUBMIT PHOTOGRAPHS OF ALL TAGGED PLANT MATERIAL PRIOR TO PURCHASE FOR APPROVAL OF THE OWNER/LANDSCAPE ARCHITECT.

THE LANDSCAPE CONTRACTOR IS RESPONSIBLE FOR WATERING ALL PLANT MATERIAL UNTIL ESTABLISHED.

**LANDSCAPE PLAN NOTES:**

- ALL QUANTITIES ARE FOR REFERENCE. CONTRACTOR TO VERIFY QUANTITIES WITH PLANS PRIOR TO BIDDING.
- ALL PLANTING BEDS SHALL HAVE A 3" CULTIVATED EDGE. CURVED BEDLINES ARE TO BE SMOOTH AND CONTINUOUS AND NOT SEGMENTED. SEE DETAIL.
- FINE GRADE AND SEED DISTURBED AREA, INCLUDE EROSION CONTROL BLANKET. SEED LIMIT IS APPROXIMATE. SEED TO LIMITS OF GRADING AND DISTURBANCE. CONTRACTOR IS RESPONSIBLE FOR RESTORATION OF ANY UNAUTHORIZED DISTURBANCE OUTSIDE OF DESIGNATED CONSTRUCTION AREA.
- THE CONTRACTOR SHALL WATER ALL NEWLY SEEDDED AREAS UNTIL SUBSTANTIAL COMPLETION AND THE SITE IS TURNED OVER TO THE PARK DISTRICT.
- SEE ALSO SPECIFICATIONS FOR PLANTING REQUIREMENTS.

**LEGEND**

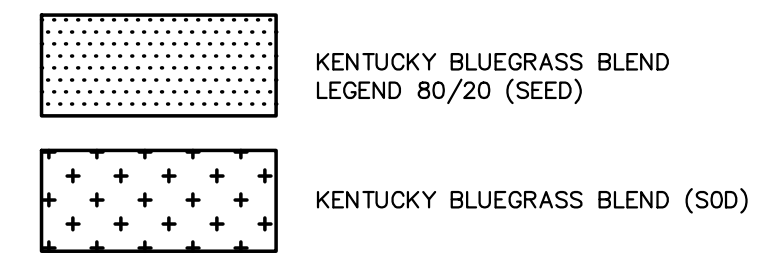

**CUMULATIVE PLANT LIST**

Code	Quantity	Size	Scientific Name	Common Name
<b>Deciduous/Evergreen Trees</b>				
ACRU	3	3" BB	Acer rubrum 'Frank Jr.'	Redpointe® Red Maple
COAL	3	8" BB	Cornus mas	Cornelian Cherry Dogwood
COMA	1	2" BB	Cornus alternifolia	Pagoda Dogwood
GIBI	2	3" BB	Ginkgo biloba	Ginkgo
GLTR	1	2.5" BB	Gleditsia triacanthos 'Skycole'	Skyline Honeylocust
PSME	2	7" BB	Pseudotsuga menziesii	Douglas Fir
QUIM	1	3" BB	Quercus imbricaria	Shingle Oak
QURO	4	3" BB	Quercus robur x Q. alba 'Cimschmidt'	Crimson Spire Oak
TICO	1	3" BB	Tilia cordata	Greenspire Littleleaf Linden
<b>Deciduous/Evergreen Shrubs</b>				
ARME	17	24" BB	Aronia melanocarpa 'Morton'	Iroquois Beauty Chokeberry
PHOP	3	24" BB	Physocarpus opulifolius	Donna May' Little Devil™ Ninebark
ROKN	8	#05 (gal)	Rosa 'Radrazz'	Knockout Rose
SPJA	3	#05 (gal)	Spirea japonica 'Neon Flash'	Neon Flash Spirea
SYDP	4	#05 (gal)	Syringa 'SMSJBP7'	Bloomerang® Dark Purple Lilac
TATA	3	30" BB	Taxus x media 'Tauntonii'	Taunton Yew
THEM	9	6" BB	Thuja occidentalis 'Smaragd'	Emerald Green Arborvitae
<b>Perennials</b>				
ALMO	43	#01 (gal)	Alchemilla mollis	Lady's Mantle
CANE	23	#01 (gal)	Calamintha nepeta ssp. Nepeta	Lesser Catmint
GEJB	33	#01 (gal)	Geranium 'Johnson's Blue'	Johnson's Blue Geranium
HEAS	200	#01 (gal)	Hemerocallis 'Apricot Sparkles'	Apricot Sparkles Daylily
NECP	27	#01 (gal)	Nepeta 'Cat's Pajamas'	Cat's Pajamas Catmint
<b>Ornamental Grasses</b>				
PAVI	15	#01 (gal)	Panicum virgatum 'Cheyenne Sky'	Cheyenne Sky Red Switch Grass
SPHE	26	#01 (gal)	Sporobolus heterolepis	Prairie Dropseed

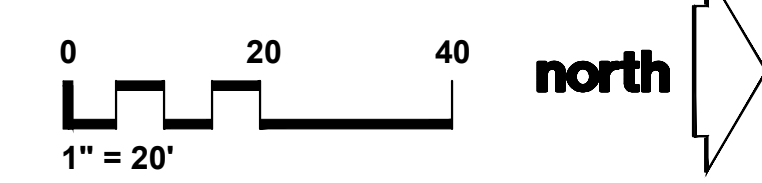

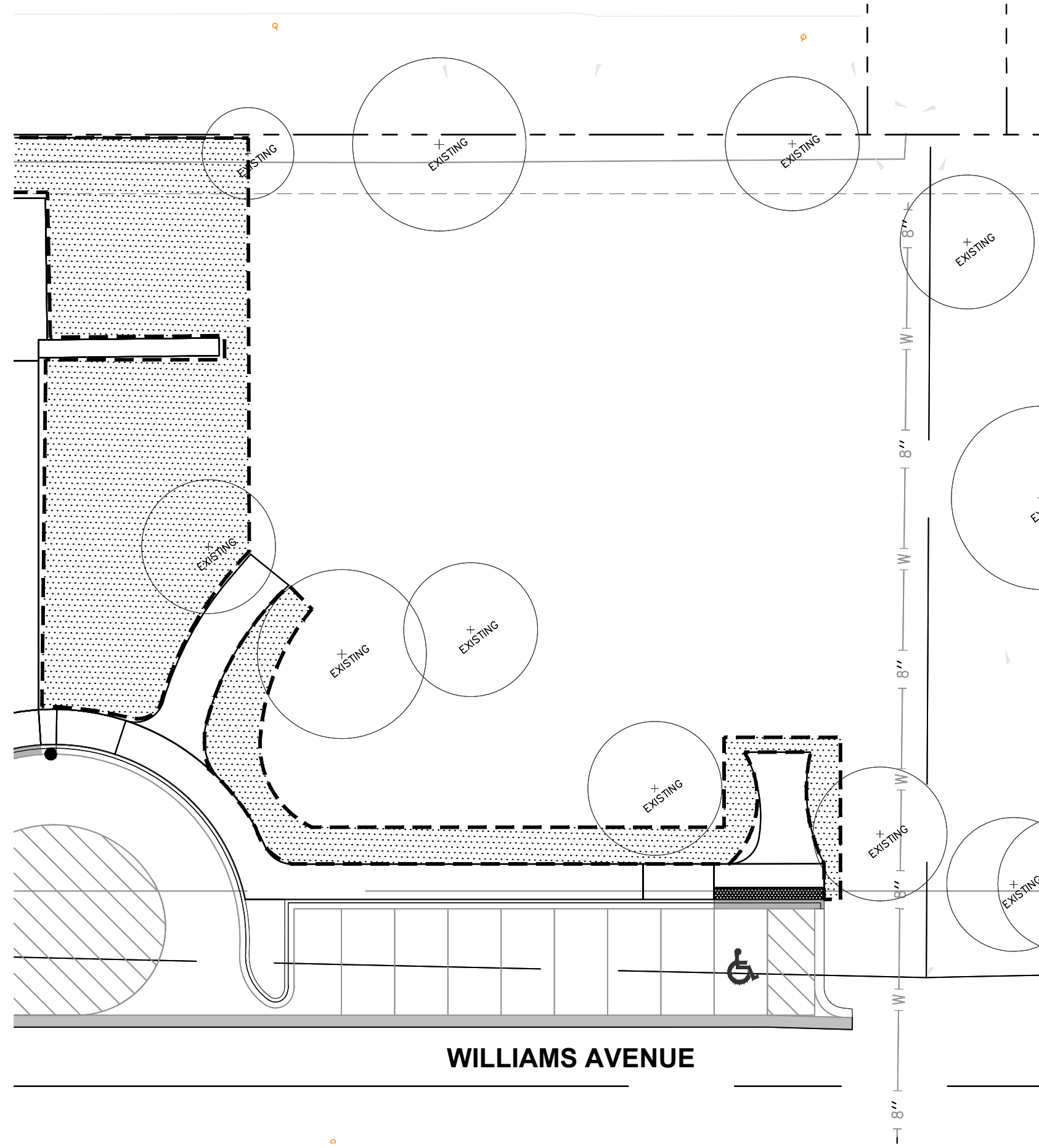

**LANDSCAPE PLAN NOTES:**

1. ALL QUANTITIES ARE FOR REFERENCE. CONTRACTOR TO VERIFY QUANTITIES WITH PLANS PRIOR TO BIDDING.
2. ALL PLANTING BEDS SHALL HAVE A 3" CULTIVATED EDGE. CURVED BEDLINES ARE TO BE SMOOTH AND CONTINUOUS AND NOT SEGMENTED. SEE DETAIL.
3. FINE GRADE AND SEED DISTURBED AREA, INCLUDE EROSION CONTROL BLANKET. SEED LIMIT IS APPROXIMATE. SEED TO LIMITS OF GRADING AND DISTURBANCE. CONTRACTOR IS RESPONSIBLE FOR RESTORATION OF ANY UNAUTHORIZED DISTURBANCE OUTSIDE OF DESIGNATED CONSTRUCTION AREA.
4. THE CONTRACTOR SHALL WATER ALL NEWLY SEEDED AREAS UNTIL SUBSTANTIAL COMPLETION AND THE SITE IS TURNED OVER TO THE PARK DISTRICT.
5. SEE ALSO SPECIFICATIONS FOR PLANTING REQUIREMENTS.

**LEGEND**

 KENTUCKY BLUEGRASS BLEND  
LEGEND 80/20 (SEED)

1  
L1.2 LANDSCAPE PLAN: NORTH

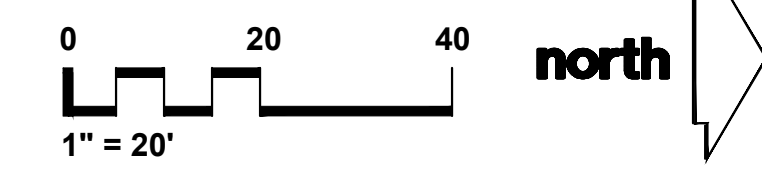

**ROSE PARK IMPROVEMENTS**  
**SALT CREEK RURAL PARK DIS**  
**530 S WILLIAMS AVE**  
**PALATINE, IL, 60074**

WA No.	2022-109
Date	06 JUNE 2023
Drawn	LMV/SD
Checked	LMV

NO.	DATE	DESCRIPTION
1	06/06/2023	ISSUE FOR BIDDING
2	08/14/2023	ISSUE FOR PERMIT REVISION 1
3	09/12/2023	ISSUE FOR PERMIT REVISION 2 IFC
4	10/24/2023	LANDSCAPE PLAN REVISIONS



**WILLIAMS ARCHITECTS**  
ARCHITECTURE | PLANNING | AQUATICS | INTERIORS  
500 Park Boulevard, Suite 800, Itasca, IL 60143  
Phone 630-221-1212 / Fax 630-221-1220

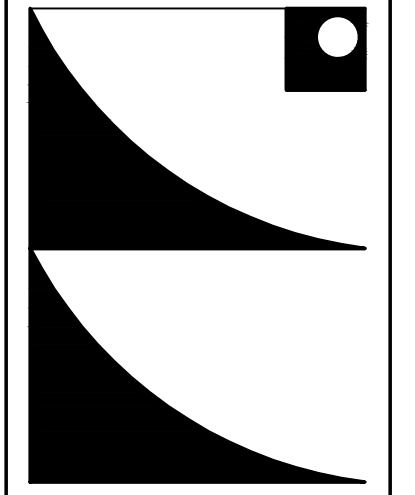

LANDSCAPE  
PLAN NORTH

**L1.2**

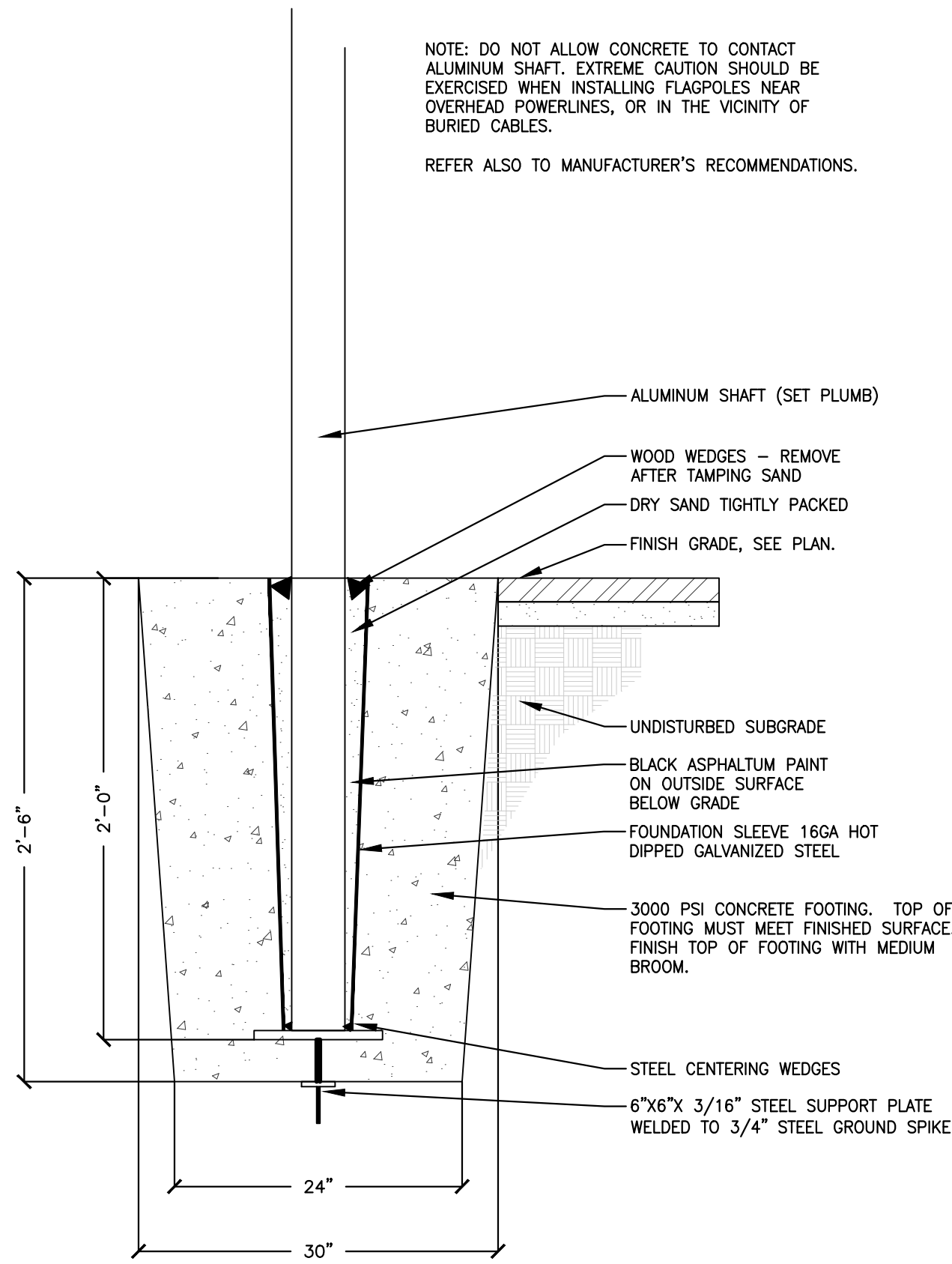

1 20' FLAGPOLE FOOTING  
L2.0 NTS

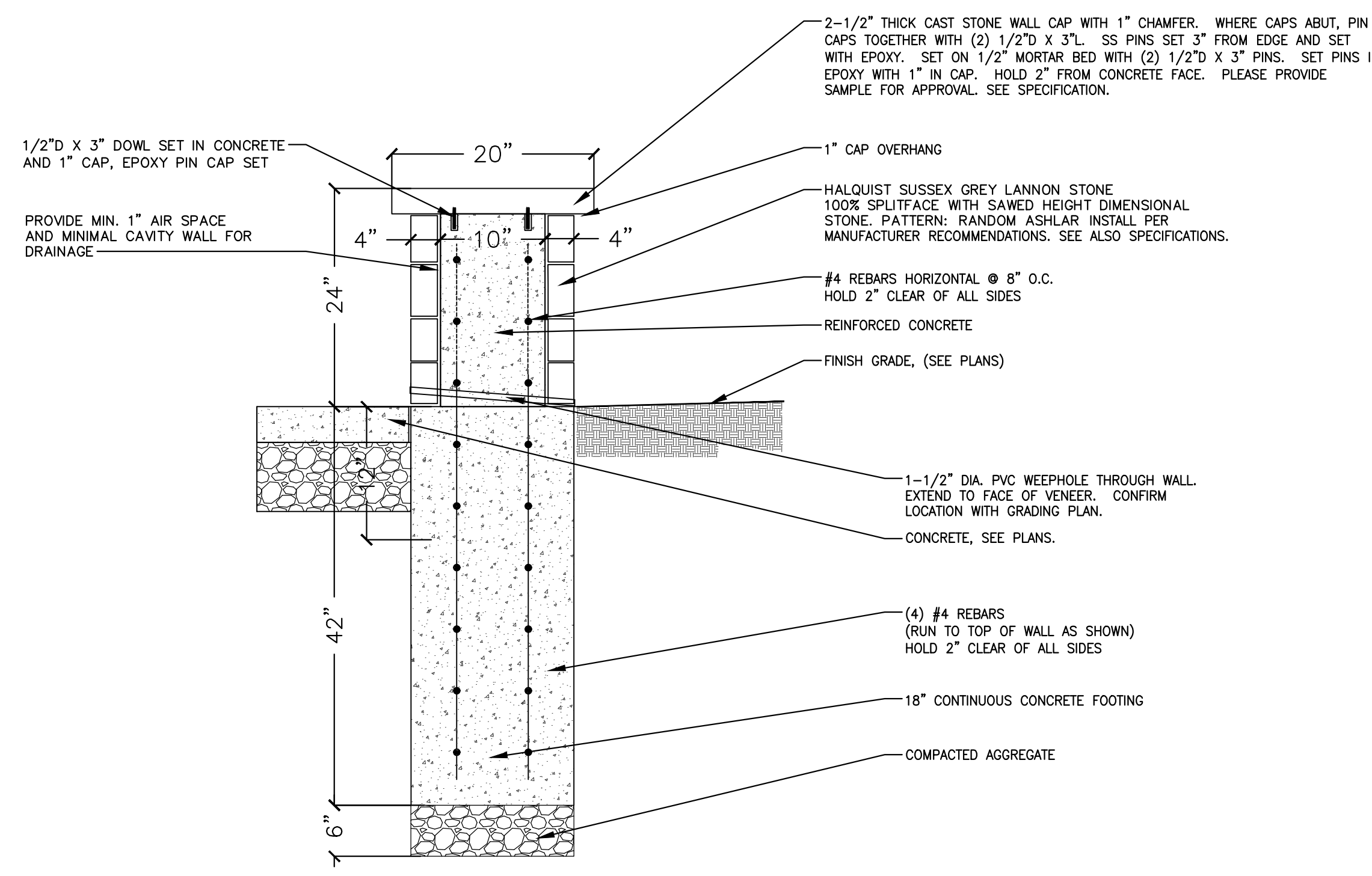

2 SEATWALL  
L2.0 NTS

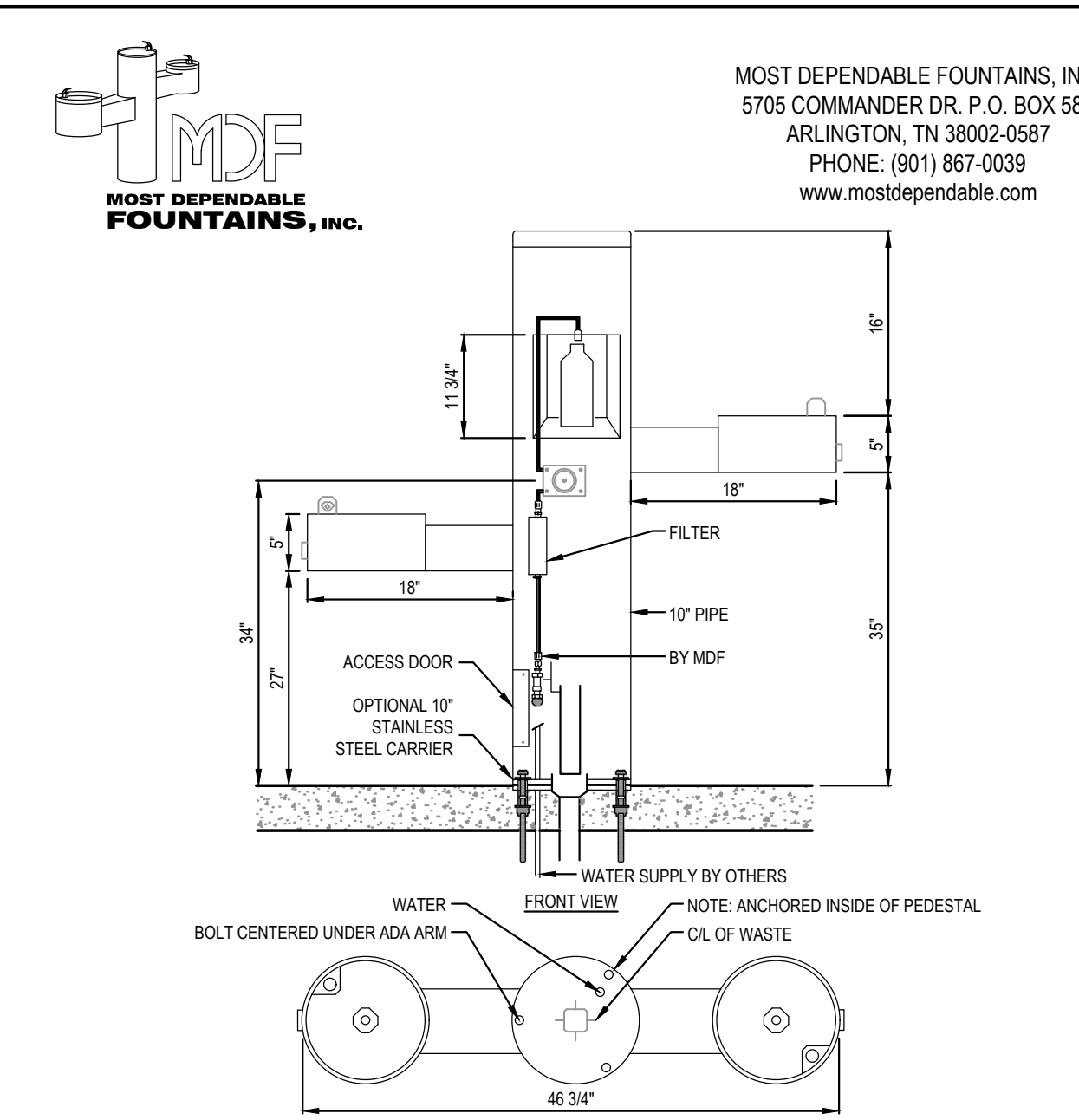

3 DRINKING FOUNTAIN  
L2.0 NTS

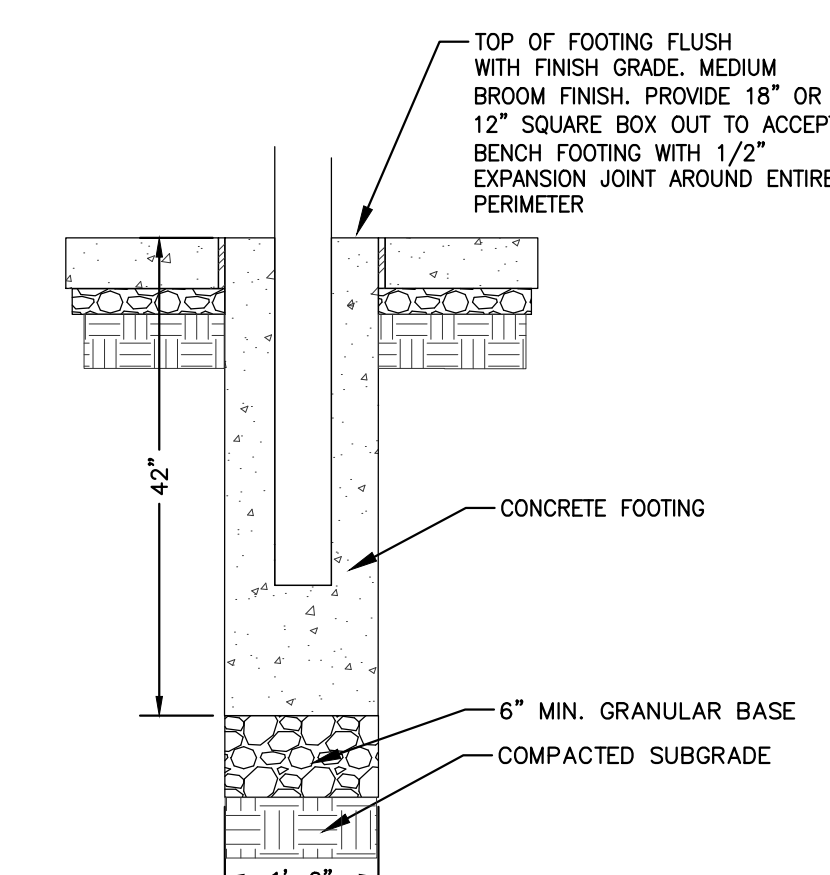

4 BENCH FOOTING  
L2.0 NTS

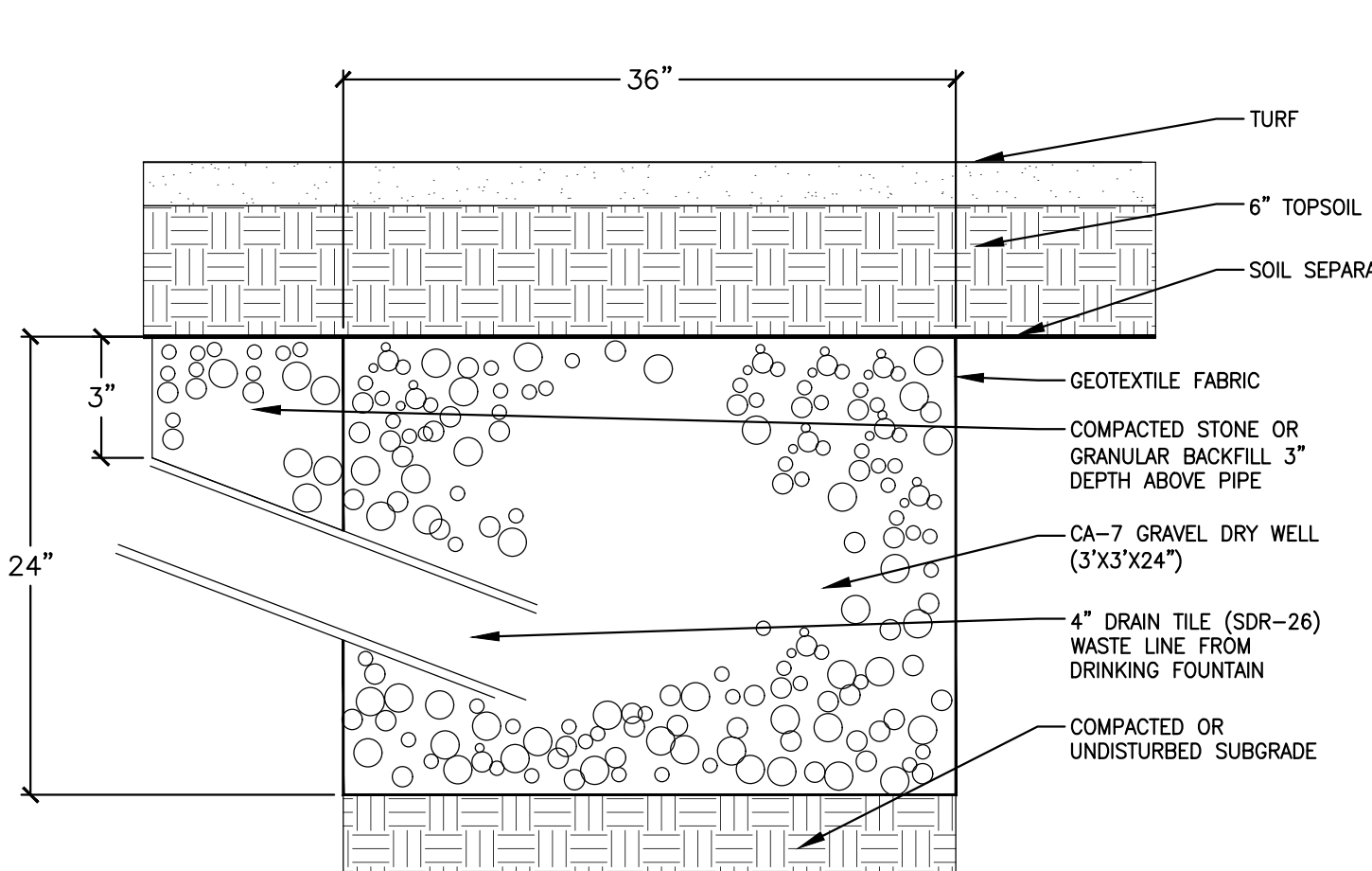

5 DRYWELL FOR DRINKING FOUNTAIN  
L2.0 NTS

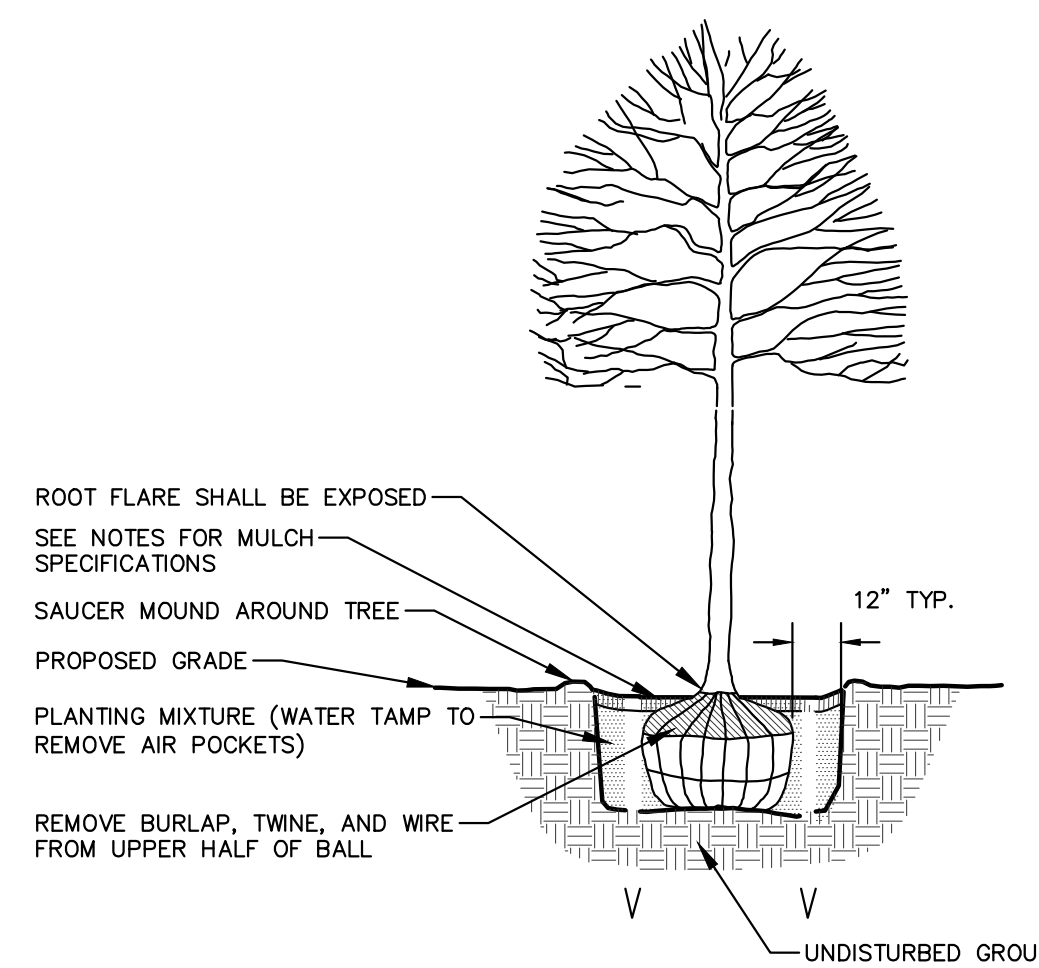

6 DECIDUOUS TREE PLANTING  
L2.0 NTS

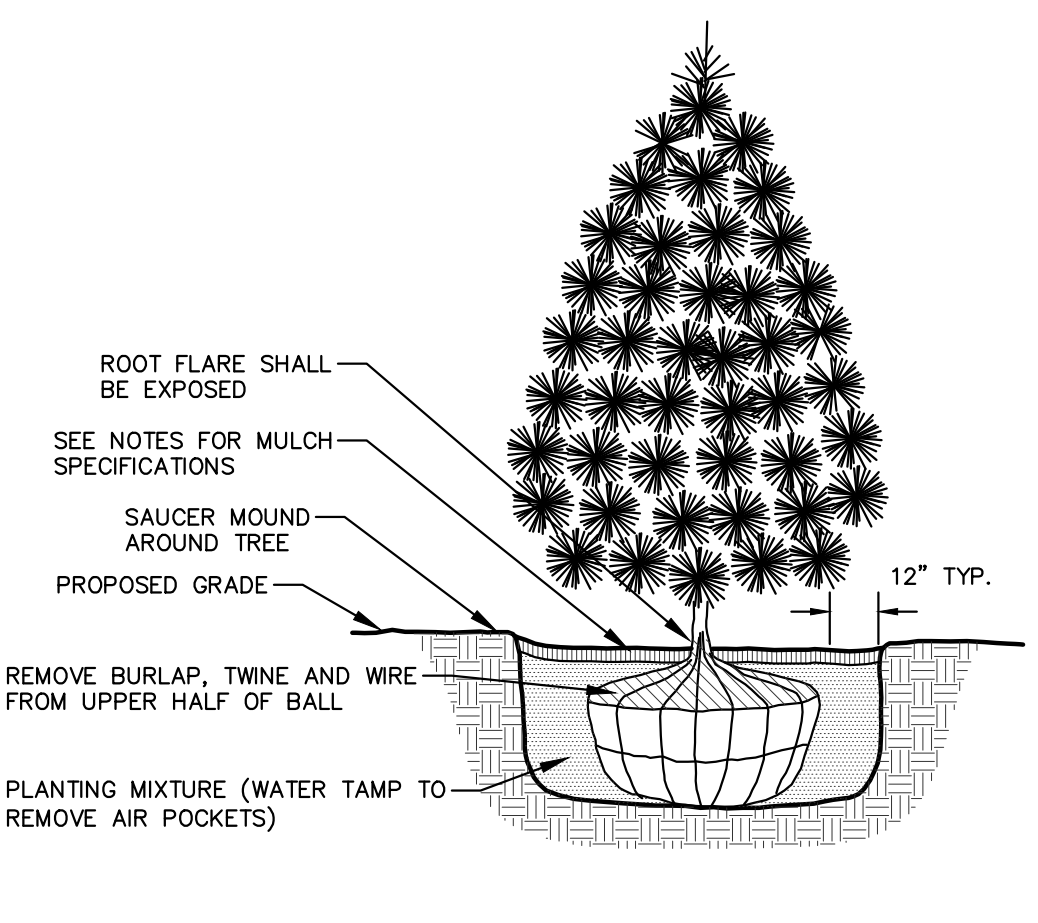

7 EVERGREEN TREE PLANTING  
L2.0 NTS

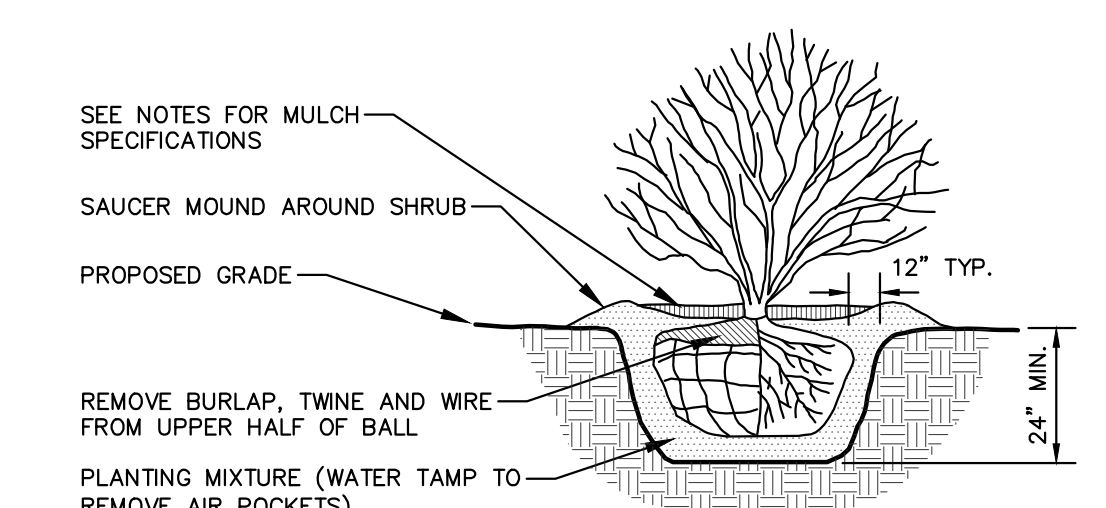

8 DECIDUOUS/EVERGREEN SHRUB PLANTING  
L2.0 NTS

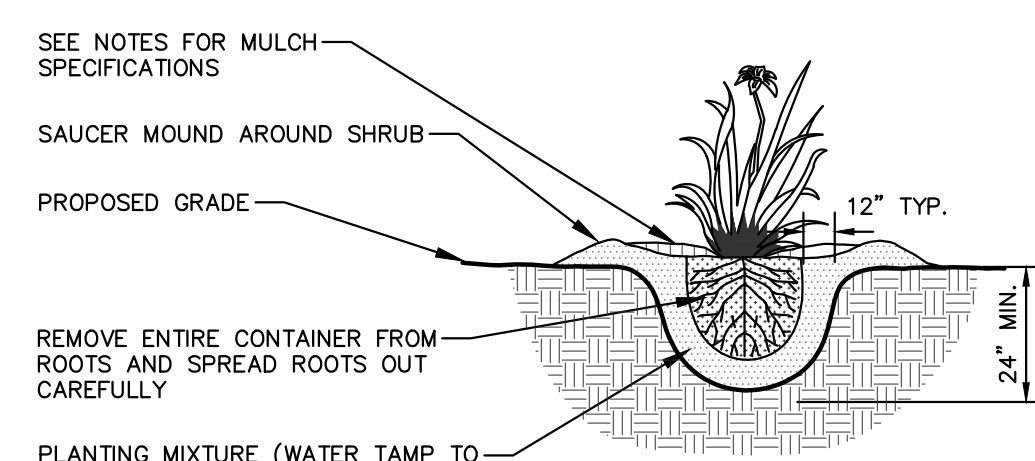

9 PERENNIAL/ORNAMENTAL GRASS PLANTING  
L2.0 NTS

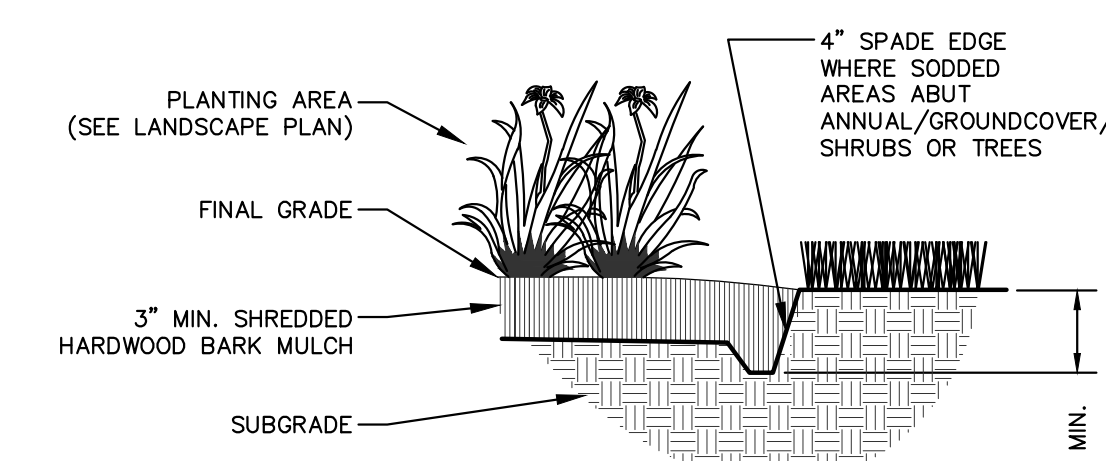

10 NATURAL SPADE EDGE  
L2.0 NTS

COPYRIGHT © 2023  
williams@jpsd.com/interiors, itd.

**ROSE PARK IMPROVEMENTS**  
**SALT CREEK RURAL PARK DIS**  
**530 S WILLIAMS AVE**  
**PALATINE, IL, 60074**

WA No. 2022-009  
Date 06 JUNE 2023  
Drawn LMV/SD  
Checked LMV

NO.	DATE	DESCRIPTION
1	06/06/2023	ISSUE FOR PERMIT REVISION 1
2	08/14/2023	ISSUE FOR PERMIT REVISION 2 IFC
3	09/12/2023	LANDSCAPE PLAN REVISIONS
4	10/24/2023	LANDSCAPE PLAN REVISIONS

**JSD**

**WILLIAMS ARCHITECTS**  
ARCHITECTURE | PLANNING | AQUATICS | INTERIORS  
500 Park Boulevard, Suite 800, Itasca, IL 60143  
Phone 630-221-1212 / Fax 630-221-1220

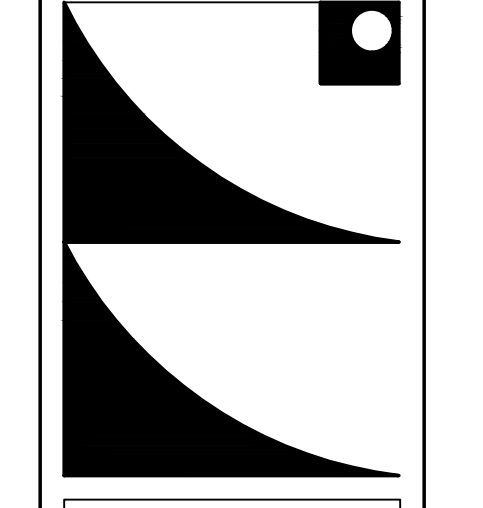

LANDSCAPE CONSTRUCTION DETAILS

**L2.0**